

616.8.33 (TA-33) Lane Closure on Left or Right Lane on Divided Highway- MT

SPEED Permanent Posted (mph)	SIGN SPACING (ft.)		TAPER LENGTH (ft.)		OPTIONAL	CHANNELIZER SPACING (ft.)	
	Undivided (S)	Divided (S)	Shoulder (1) (T1)	Lane (2) (T2)	BUFFER LENGTH (ft.) (B)	Tapers	Buffer/ Work Areas
0-35	-	200	70	245	280	35	40
40-45	-	500	150	540	400	40	80
50-55	-	1000	185	660	560	50	80
60-70	-	SA - 1000 SB - 1500 SC - 2640	235	840	840	60	120

1 Shoulder taper length based on 10 ft. (standard shoulder width) offset. 2. Lane taper length based on 12 ft. (standard lane width) offset.

	SIGN HEIGHT	MAXIMUM WORK ZONE LENGTH (L)
URBAN	1' Portable 7' Post	1 Mi.
RURAL UNDIVIDED	1' Portable 7' Post	2 Mi.

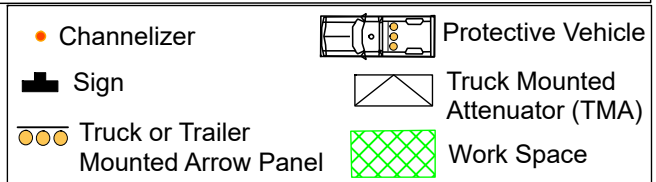

A protective vehicle shall be used while work is in progress.

The protective vehicle shall be equipped with a TMA and shall have a flashing arrow panel and positioned at least 150 ft. in advance of the work space, if possible.

The work vehicle may be used as the protective vehicle if all the following conditions are met:

- The roadway is posted at 45 mph or below,
- The work vehicle is positioned in advance of the work space,
- The work vehicle has a flashing arrow panel, and
- The work vehicle uses activated rotating lights or strobe lights.

All vehicles, equipment, workers and their activities should be restricted to one side of the pavement.

The open lane shall be provided with a 10 ft. minimum driving surface at all times. This may include a portion of the shoulder, provided the shoulder is of adequate strength to handle traffic.

For short duration operations, signs and channelizers may be reduced or eliminated.

For operations where workers are on foot and move with the operation, channelizers may be reduced or eliminated.

For operations in which channelizers are not used, the arrow mode shall be displayed on any flashing arrow panel located downstream of the taper.

Supplemental warning methods may be used to call attention to the work zone.

Additional warning signs shall be erected at each intersection with another state highway within the work zone. Upon the discretion of the supervisor, additional warning signs may be erected at other intersections within the work zone.

For nighttime operations, review EPG 616.6.83 WARNING LIGHTS for use of sequential lights.

If rumble strips are used, review EPG 616.6.87 RUMBLE STRIPS.

For long-term operations, EPG 616.6.2.2 Flags and Advance Warning Rail System.

SEE EPG 616.12 WORK ZONE SPEED LIMITS FOR SPEED LIMIT GUIDELINES.

